

Totally enclosed fan-cooled (IE3)(*1)

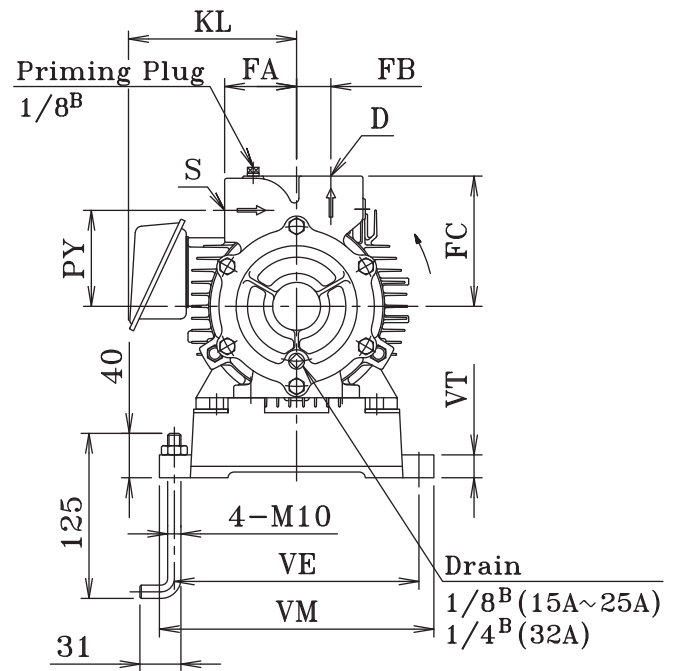
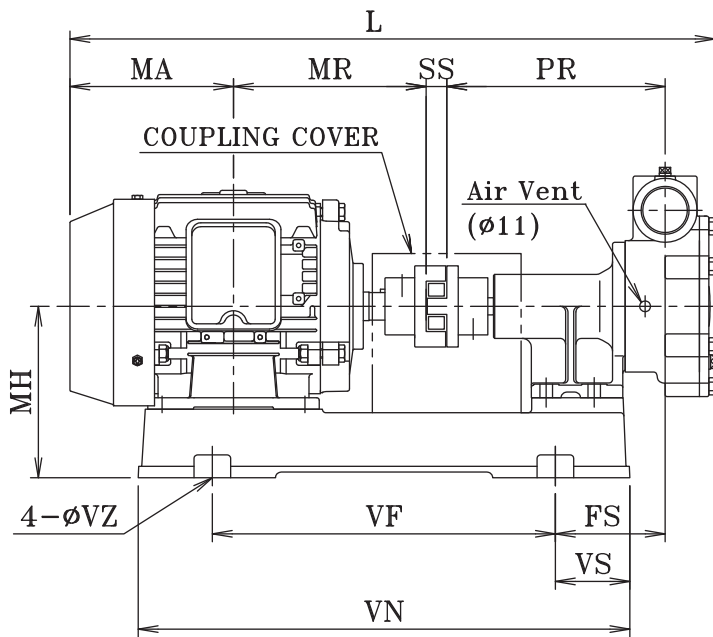

Dimension and Weights

(Unit:mm,kg)

Model	kW	S·D	PR	PY	FA	FB	FS	FC	MH	L	MA	MR	SS	VE	VF	VM	VN	VS	VT	VZ	KL	Weight
15UL	0.2	Rc1/2	190	52	60	20	89	78	115	452	109	103	14	170	220	196	335	57	12	12	-	16
20UL	0.2	Rc3/4	194	66	50	22	93	85	115	453.5	109	103	14	170	220	196	335	57	12	12	-	21
	0.4	Rc3/4	194	66	50	22	90	85	130	482.5	121	120	14	184	245	210	357	56	20	12	-	25
25UL	0.75	Rc3/4	194	66	50	22	92	85	140	521.5	140	140	14	199	269	225	385	58	20	12	146	35
	0.4	Rc1	194.5	72	60	26	90.5	95	130	483	121	120	14	184	245	210	357	56	20	12	-	26
	0.75	Rc1	194.5	72	60	26	92.5	95	140	522	140	140	14	199	269	225	385	58	20	12	146	36
32UL	1.5	Rc1	194.5	72	60	26	99.5	95	150	579	154.5	168.5	18	214	300	240	430	65	20	12	156	42
	0.4	Rc1 1/4	191	84	63	30	87	114	130	485	121	120	14	184	245	210	357	56	20	12	-	28
	0.75	Rc1 1/4	191	84	63	30	89	114	140	524	140	140	14	199	269	225	385	58	20	12	146	38
	1.5	Rc1 1/4	191	84	63	30	96	114	150	586.5	154.5	168.5	18	214	300	240	430	65	20	12	156	44

-Remarks-

Dimensions and weights shown in above table reflected to Totally Enclosed Fan Cooled type motor. Values will be slightly different when other type of motor is being used.

*1 Motor for 0.75kW or greater sizes is complied with IE3 standard.