

Totally enclosed fan-cooled (IE3)(\*1)

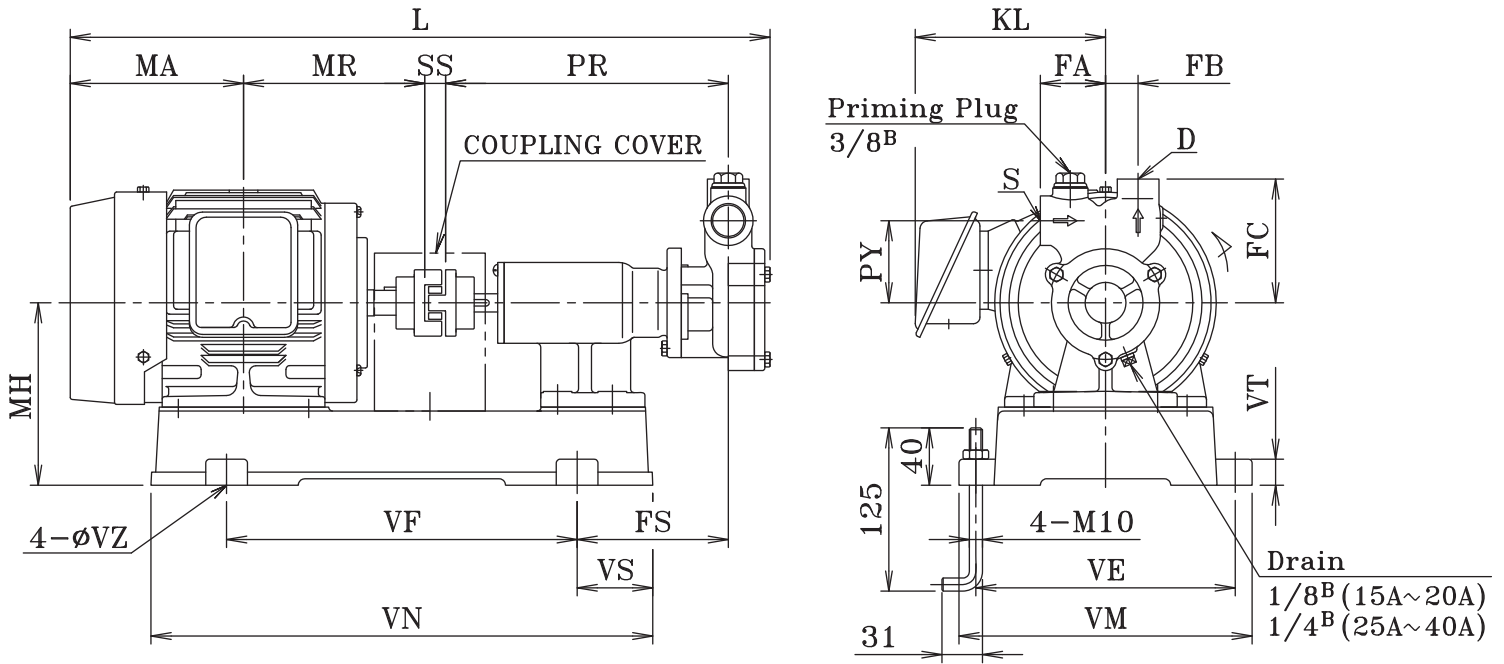

Dimension and Weights

(Unit:mm,kg)

Model	kW	S	D	PR	PY	FA	FB	FS	FC	MH	L	MA	MR	SS	VE	VF	VM	VN	VS	VT	VZ	KL	Weight
15NP	0.4	Rc1/2	Rc3/8	219	52	45	21	115	81	130	505	121	120	14	184	245	210	357	56	20	12	-	18
20NP	0.4	Rc3/4	Rc1/2	218	63	50	25	114	95	130	505	121	120	14	184	245	210	357	56	20	12	-	20
	0.75	Rc3/4	Rc1/2	218	63	50	25	116	95	140	526	122	140	14	199	269	225	385	58	20	12	146	27
25NP	0.75	Rc1	Rc3/4	224	70	60	28	122	105	140	538.5	122	140	14	199	269	225	385	58	20	12	146	27
	1.5	Rc1	Rc3/4	224	70	60	28	129	105	150	603.5	154.5	168.5	18	214	300	240	430	65	20	12	156	36
32NP	1.5	Rc1 1/4	Rc1	224	80	65	35	129	120	150	609	154.5	168.5	18	214	300	240	430	65	20	12	156	37
	2.2	Rc1 1/4	Rc1	224	80	65	35	129	120	150	609	154.5	168.5	18	214	300	240	430	65	20	12	156	41.5
40NP	2.2	Rc1 1/2	Rc1 1/4	238	85	70	40	123	130	145	629	154.5	168.5	18	230	350	260	500	75	15	12	156	44.5
	3.7	Rc1 1/2	Rc1 1/4	238	85	70	40	82	130	180	692	186	200	18	280	425	310	616	96	25	12	175	61

-Remarks-

Dimensions and weights shown in above table reflected to Totally Enclosed Fan Cooled type motor. Values will be slightly different when other type of motor is being used.

\*1 Motor for 0.75kW or greater sizes is complied with IE3 standard.