

0.4kW,0.75kW,1.5kW,2.2kW(Increased safety explosion proof(*1))

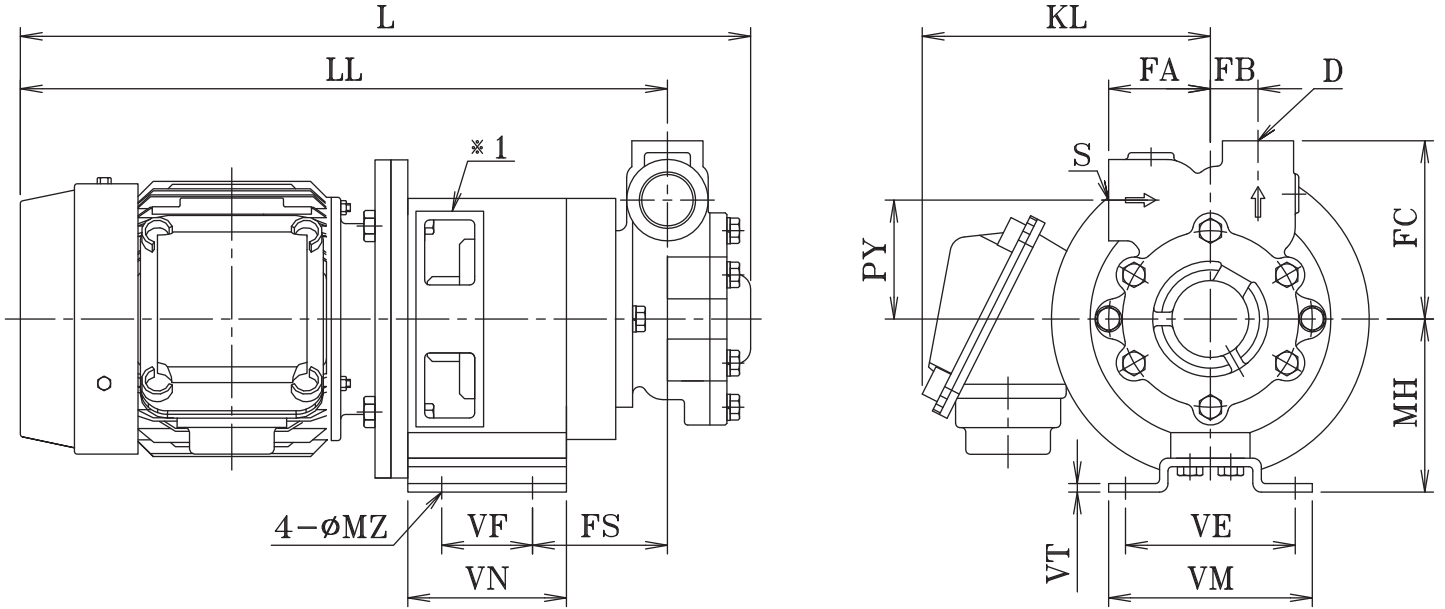

Dimension and Weights

(Unit:mm,kg)

Model	kW	S	D	LL	PY	FA	FB	FC	MH	FS	L	VE	VF	VM	VN	MZ	VT	KL	Weight	
ISEP*3	20NLMS04A	0.4	Rc3/4	Rc1/2	342	63	50	25	95	88	31.5	391	100	54	120	93	10	5	175	16.5
	20NLMS07A	0.75	Rc3/4	Rc1/2	369.5	63	50	25	95	105	45	418.5	100	54	120	93	10	5	181	27.5
	20NLMS15A	1.5	Rc3/4	Rc1/2	430.5	63	50	25	95	105	63	479.5	100	54	120	93	10	5	195	38
	20NLMS22A	2.2	Rc3/4	Rc1/2	469.5	63	50	25	95	130	63	518.5	140	54	160	93	10	5	210	58
	25NLMS07A	0.75	Rc1	Rc3/4	369.5	70	60	28	105	105	51	422.5	100	54	120	93	10	5	181	30
	25NLMS15A	1.5	Rc1	Rc3/4	430.5	70	60	28	105	105	63	483.5	100	54	120	93	10	5	195	40.5
	25NLMS22A	2.2	Rc1	Rc3/4	469.5	70	60	28	105	130	63	522.5	140	54	160	93	10	5	210	60.5
	32NLMS15A	1.5	Rc1 1/4	Rc1	438.5	80	65	35	120	105	71	495.5	100	54	120	93	10	5	195	42.5
	32NLMS22A	2.2	Rc1 1/4	Rc1	477.5	80	65	35	120	130	71	534.5	140	54	160	93	10	5	210	62.5

-Remarks-

Dimensions for NLMB and NLMS are identical.