

Totally enclosed fan-cooled (IE3)(*1)

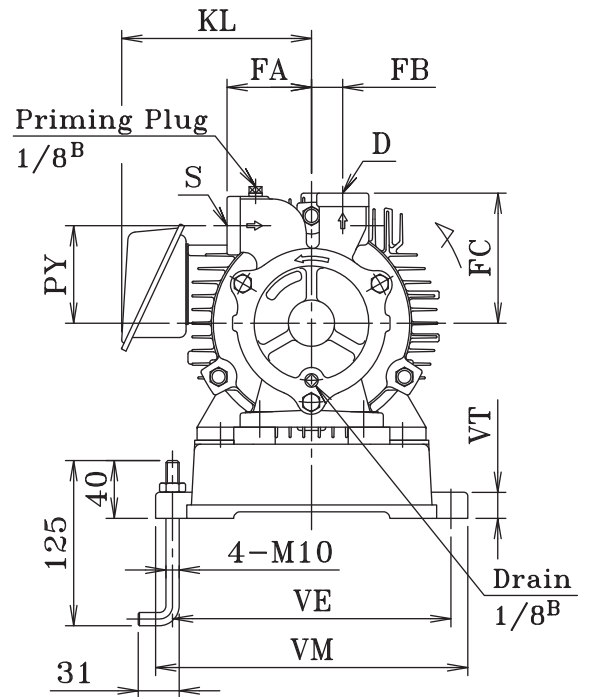
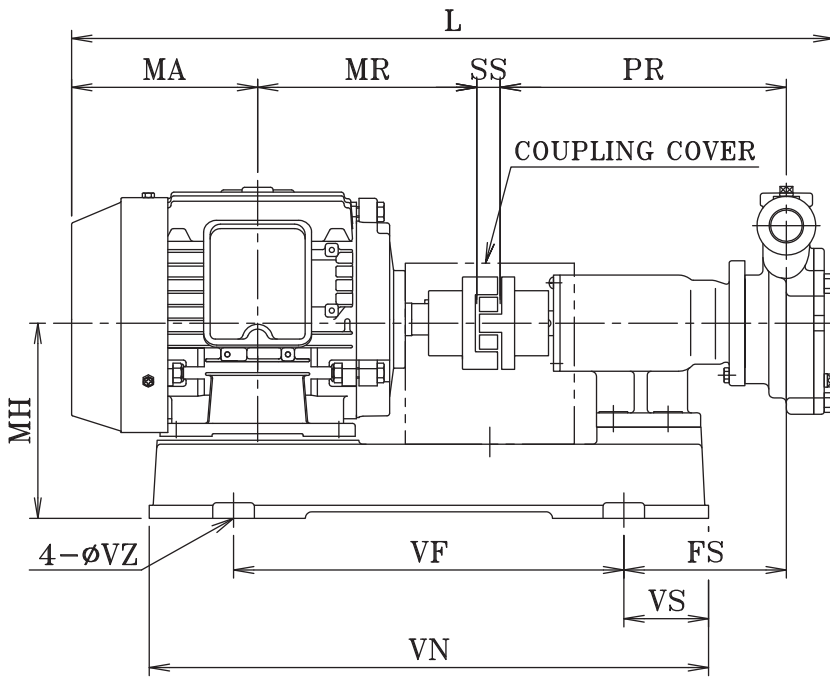

Dimension and Weights

(Unit:mm,kg)

Model	kW	S	D	PR	PY	FA	FB	FS	FC	MH	L	MA	MR	SS	VE	VF	VM	VN	VS	VT	VZ	KL	Weight
20NH-V	0.75	Rc3/4	Rc1/2	220	75	65	24	118	100	140	532.5	122	140	14	199	269	225	385	58	20	12	146	28
	1.5	Rc3/4	Rc1/2	220	75	65	24	125	100	150	597.5	154.5	168.5	18	214	300	240	430	65	20	12	156	37
25NH-V	1.5	Rc1	Rc3/4	220	75	65	24	125	100	150	597.5	154.5	168.5	18	214	300	240	430	65	20	12	156	38
	2.2	Rc1	Rc3/4	220	75	65	24	125	100	150	597.5	154.5	168.5	18	214	300	240	430	65	20	12	156	42.5

-Remarks-

Dimensions and weights shown in above table reflected to Totally Enclosed Fan Cooled type motor. Values will be slightly different when other type of motor is being used.

*1 Motor for 0.75kW or greater sizes is complied with IE3 standard.