

Totally enclosed fan-cooled (IE3)(\*1)

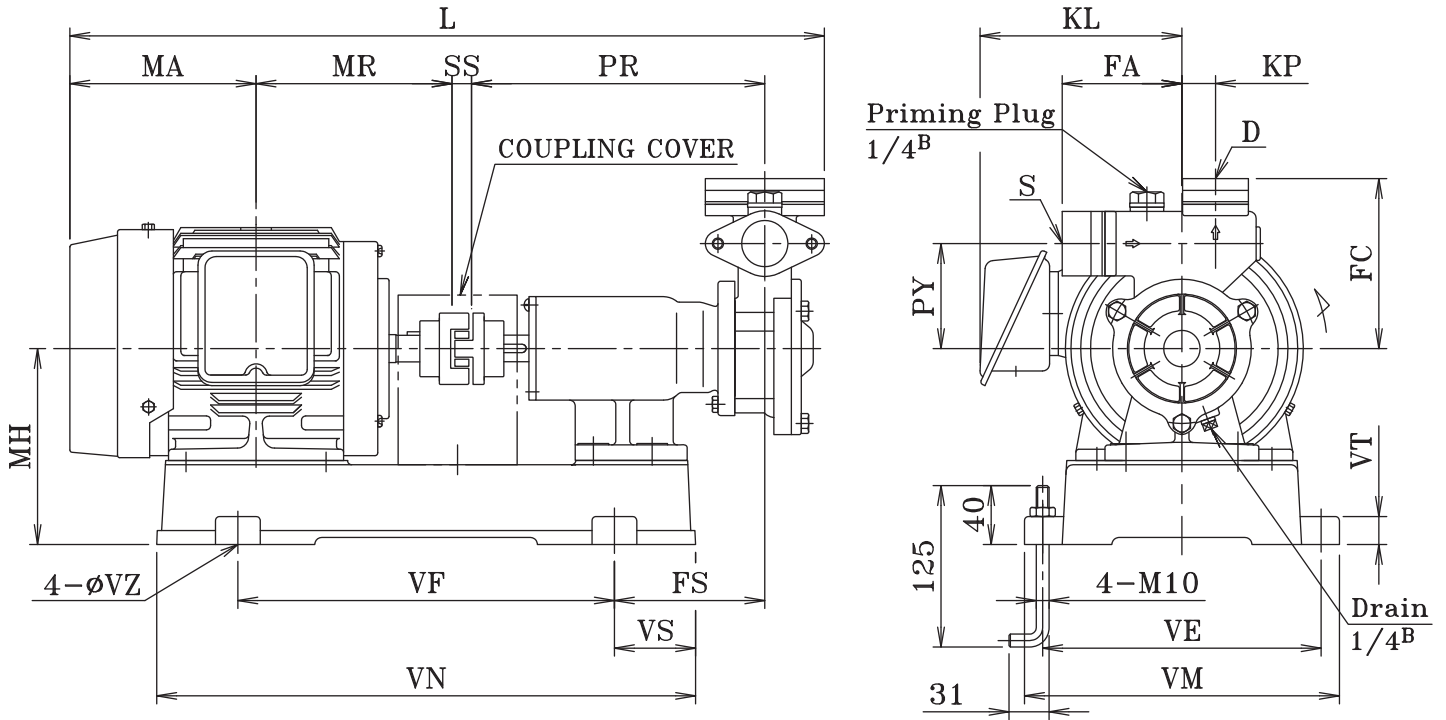

Dimension and Weights

(Unit:mm,kg)

Model	kW	S·D	PR	PY	FA	FB	FS	FC	MH	L	MA	MR	SS	VE	VF	VM	VN	VS	VT	VZ	KL	Weight
15KP-V	0.4	Rc1/2	204.5	57	70.5	18	101	93	130	492	121	120	14	184	245	210	357	56	20	12	-	18
20KP-V	0.4	Rc3/4	203.5	66	76	21	100	106	130	497.5	121	120	14	184	245	210	357	56	20	12	-	20
	0.75	Rc3/4	203.5	66	76	21	102	106	140	518.5	122	140	14	199	269	225	385	58	20	12	146	27
25KP-V	0.75	Rc1	208.5	75	85.5	24	107	121.5	140	527	122	140	14	199	269	225	385	58	20	12	146	27
	1.5	Rc1	208.5	75	85.5	24	114	121.5	150	592	154.5	168.5	18	214	300	240	430	65	20	12	156	36
32KP-V	1.5	Rc1 1/4	208	82	92	26	113	133	150	596	154.5	168.5	18	214	300	240	430	65	20	12	156	37
	2.2	Rc1 1/4	208	82	92	26	113	133	150	596	154.5	168.5	18	214	300	240	430	65	20	12	156	41.5
40KP-V	1.5	Rc1 1/2	207	84	94	27	112	136	150	598	154.5	168.5	18	214	300	240	430	65	20	12	156	37
	2.2	Rc1 1/2	207	84	94	27	112	136	150	598	154.5	168.5	18	214	300	240	430	65	20	12	156	41.5

-Remarks-

Dimensions and weights shown in above table reflected to Totally Enclosed Fan Cooled type motor. Values will be slightly different when other type of motor is being used.

\*1 Motor for 0.75kW or greater sizes is complied with IE3 standard.