

Totally enclosed fan-cooled (IE3)(*1)

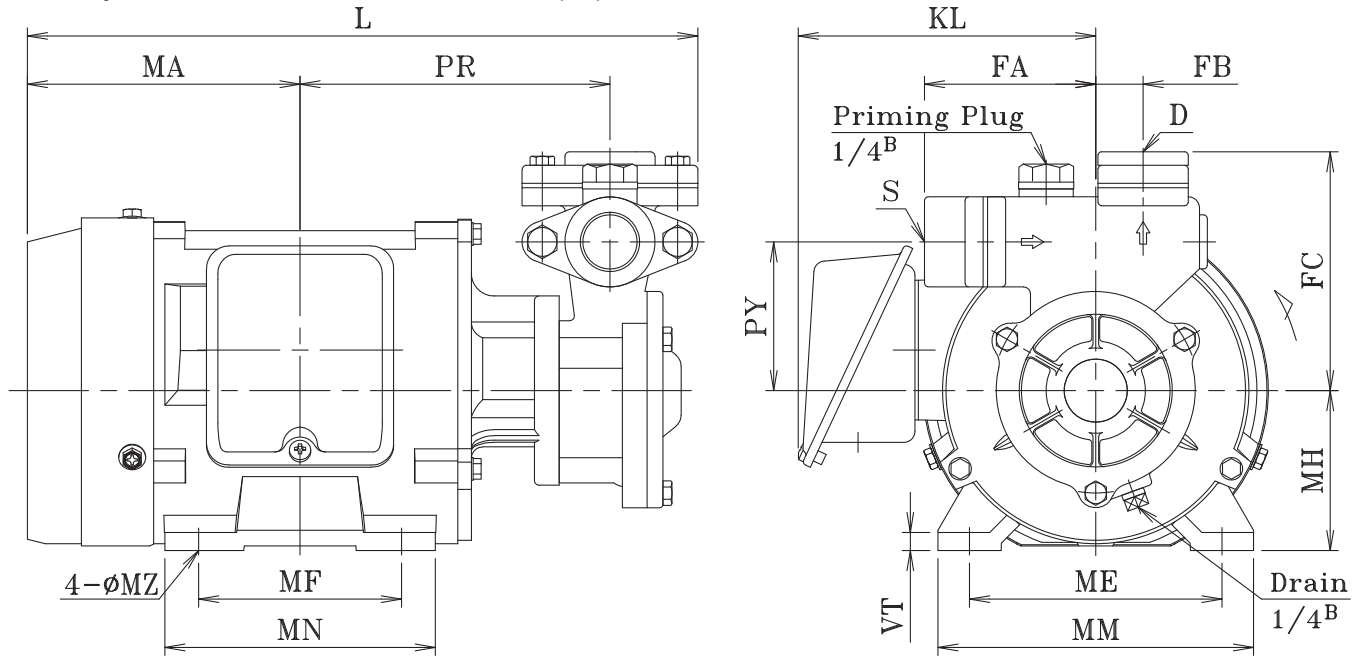

Single phase, open drip proof(*2)

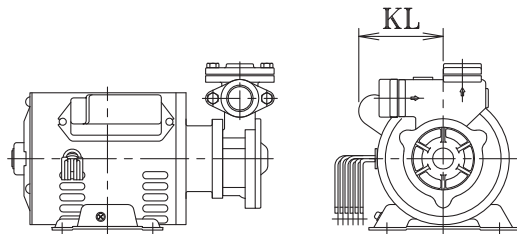

Increased safety explosion proof(*3)

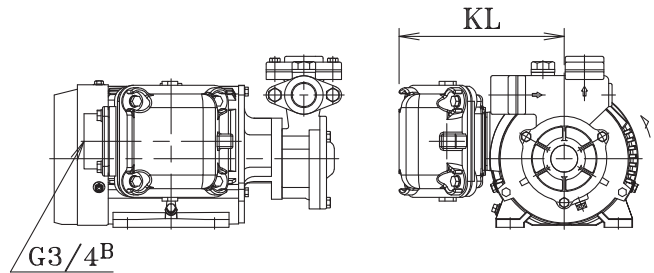

Dimension and Weights (*4)

(Unit:mm,kg)

	Model	kW	S·D	PR	PY	FA	FB	FC	MH	L	MA	ME	MF	MM	MN	MZ	VT	KL	Weight
TEFCM(*1)	15KPD02Z	0.31	Rc1/2	137.5	57	70.5	18	93	71	291	121	112	90	140	120	8×10	8	132	10.5
	20KPD04Z	0.56	Rc3/4	137.5	66	76	21	106	71	297.5	121	112	90	140	120	8×10	8	132	12
	25KPD07Z	0.975	Rc1	130	75	85.5	24	121.5	80	312.5	140	125	100	155	125	10×12	8	147	22
	25KPD15Z	1.95	Rc1	153	75	85.5	24	121.5	90	350	154.5	140	125	176	149	10×12	10	156	26
	32KPD07Z	0.975	Rc1 1/4	128.5	82	92	26	133	80	315.5	140	125	100	155	125	10×12	8	147	23
	32KPD15Z	1.95	Rc1 1/4	151.5	82	92	26	133	90	353	154.5	140	125	176	149	10×12	10	156	27
40KPD15Z	1.95	Rc1 1/2	152.5	84	94	27	136	90	357	154.5	140	125	176	149	10×12	10	156	27	
SPIM(*2)	15KPD01S	0.15	Rc1/2	137.5	52	67	16.5	89	71	268	98	112	90	150	110	7×20	3.2	86	9
	15KPD02S	0.3	Rc1/2	137.5	57	70.5	18	93	71	268	98	112	90	150	110	7×20	3.2	86	13
	20KPD04S	0.56	Rc3/4	151	66	76	21	106	80	305	115	125	100	167	125	10×17	3.2	91	15
ISM(*3)	15KPD02A	0.31	Rc1/2	137.5	57	70.5	18	93	71	291	121	112	90	140	120	7	8	171	19
	20KPD04A	0.56	Rc3/4	137.5	66	76	21	106	71	297.5	121	112	90	140	120	7	8	171	20
	25KPD07A	0.975	Rc1	130	75	85.5	24	121.5	80	312.5	140	125	100	155	125	10	8	181	24
	25KPD15A	1.95	Rc1	153	75	85.5	24	121.5	90	379	183.5	140	125	172	149	10	10	195	37.5
	32KPD07A	0.975	Rc1 1/4	128.5	82	92	26	133	80	315.5	140	125	100	155	125	10	8	181	25
	32KPD15A	1.95	Rc1 1/4	151.5	82	92	26	133	90	382	183.5	140	125	172	149	10	10	195	37.5
40KPD15A	1.95	Rc1 1/2	152.5	84	94	27	136	90	386	183.5	140	125	172	149	10	10	195	37.5	

Remarks-

Threaded counter flange with rhombus shape in accordance with Nikuni's standard.

Material of the terminal box for Totally Enclosed Fan Cooled motor (0.31 to 0.56kW) is plastic.

*1 Motor for 0.75kW or greater sizes is complied with IE3 standard.

*2 Two capacitors are implemented onto 0.56 kW motor. One for starting and another one for running purpose.

*4 Actual output power value for Extra-loaded corresponded motor.