

Totally enclosed fan-cooled (IE3)(*1)

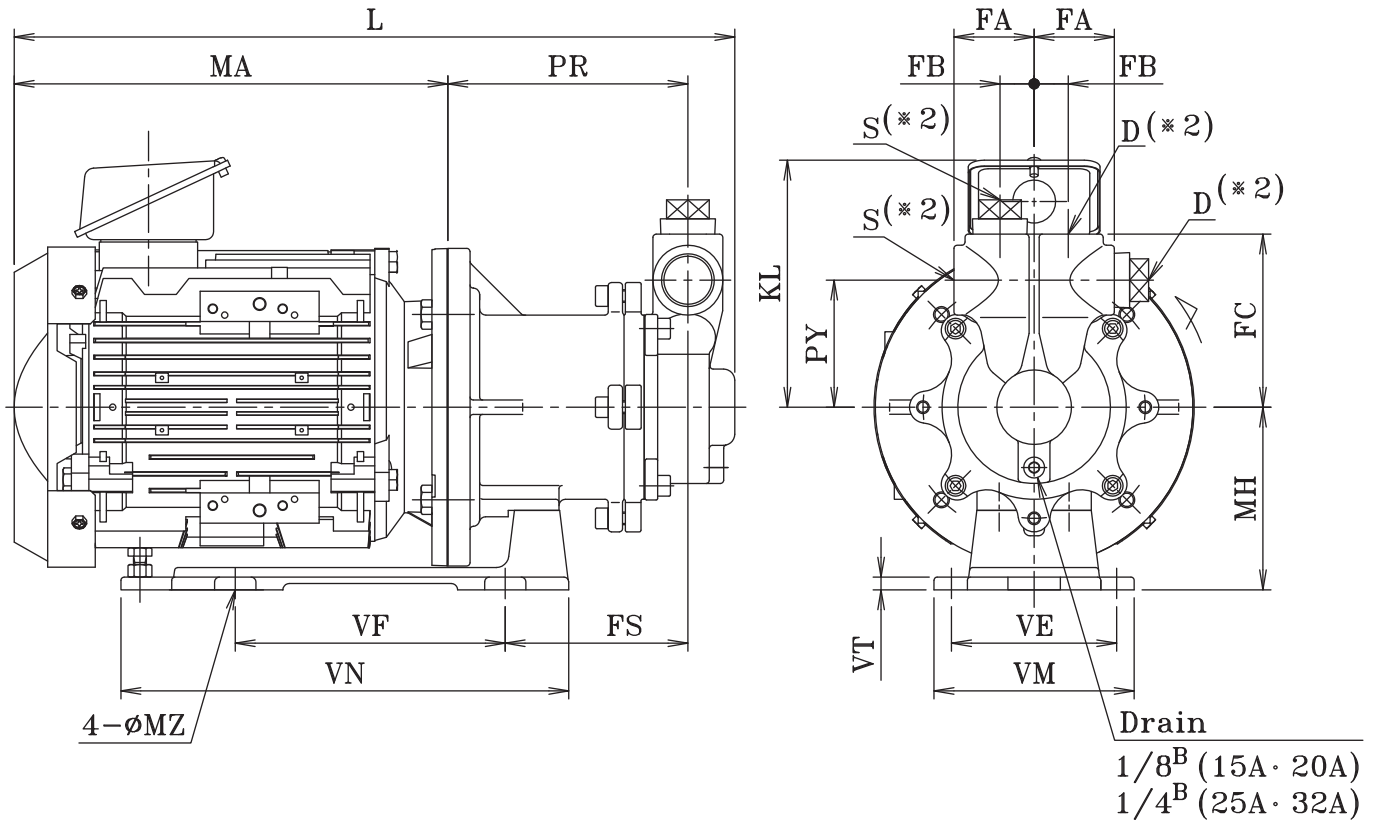

Dimension and Weights

(Unit:mm,kg)

MODEL	kW	S	D	PR	PY	FA	FB	FC	MH	FS	L	MA	VE	VF	VM	VN	MZ	VT	KL	Weight
15GNLM04Z	0.4	Rc1/2	Rc1/2	84.5	61	36	15	84	100	65	333.5	226	104	170	126	282	10	8	123	18
15GNLM07Z	0.75	Rc1/2	Rc1/2	101.5	61	36	15	84	115	65	360	235.5	104	170	126	282	10	8	145	24
20GNLM07Z	0.75	Rc3/4	Rc3/4	127	64.5	42.5	18	89	115	105	387	235.5	104	170	126	282	10	8	145	24
20GNLM15Z	1.5	Rc3/4	Rc3/4	140	64.5	42.5	18	89	115	105	437.5	273	104	170	126	282	10	8	156	33
25GNLM15Z	1.5	Rc1	Rc1	151	80	50.5	21.5	109	115	115	454	273	104	170	126	282	10	8	156	34
25GNLM22Z	2.2	Rc1	Rc1	151	80	50.5	21.5	109	115	115	483	302	104	170	126	282	10	8	156	37
32GNLM22Z	2.2	Rc1 1/4	Rc1 1/4	151	86	62.5	26.5	125	115	115	485	302	104	170	126	282	10	8	156	39
32GNLM37Z	3.7	Rc1 1/4	Rc1 1/4	168.5	86	62.5	26.5	125	140	115	526	326	104	170	126	282	10	8	175	45

-Remarks-

Values of KL, L, MA are for reference purpose only.

*1 Motor for 0.75kW or greater sizes is complied with IE3 standard.

*2 S (Suction) and D (Discharge) can be connected by selecting each one of both ports. Drawing shown in above is the configuration when shipped from factory.